

LANDSCAPE RESOURCE SURVEY
 University of Oregon Campus Heritage Landscape Plan
 Eugene, Lane County, Oregon • Spring 2007

RESOURCE IDENTIFICATION & SUMMARY

LANDSCAPE AREA NAME

Memorial Quadrangle (m)

HISTORIC NAME(S)

Kincaid Field; Memorial Quadrangle

CAMPUS PLAN DESIGNATION

Quadrangle

CURRENT HISTORIC DESIGNATION

National Register - full listing
 name: Library & Memorial Quad

ERA(S) OF GREATEST SIGNIFICANCE

Lawrence/Cutbert Era

LEVEL OF SIGNIFICANCE

High

LEVEL OF INTEGRITY

Excellent

RANKING

Primary

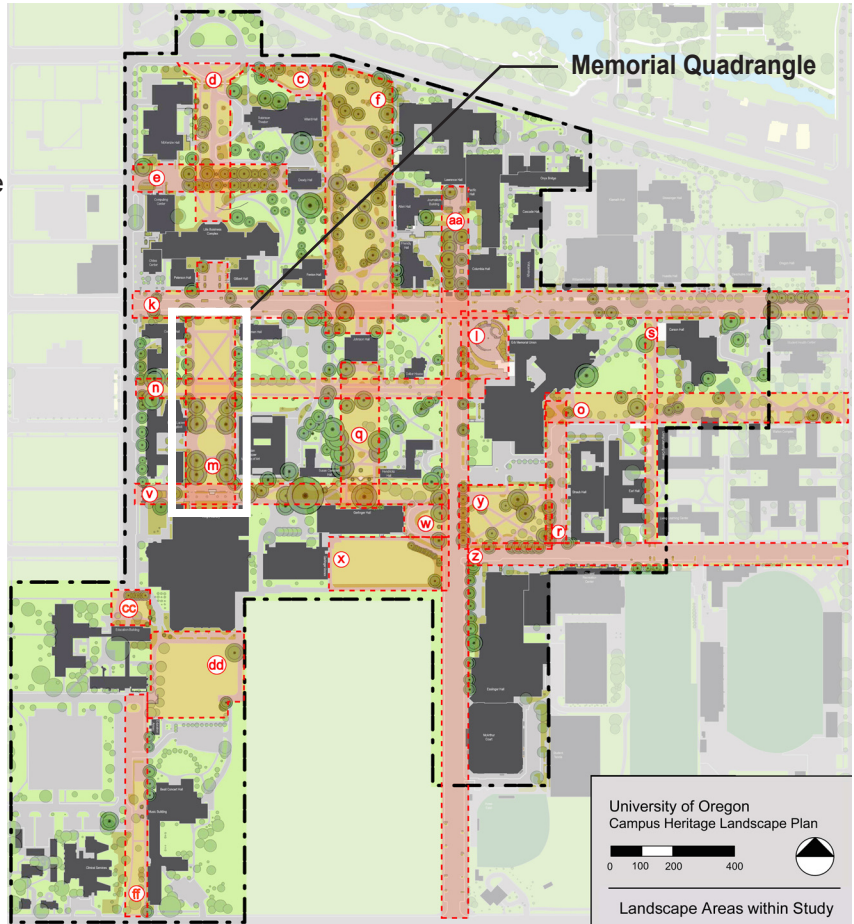

View looking south towards Knight Library.



Landscape Resource Survey
MEMORIAL QUADRANGLE

LANDSCAPE AREA SITE MAP — Highlighting existing elements from the period of significance (1876-1974).

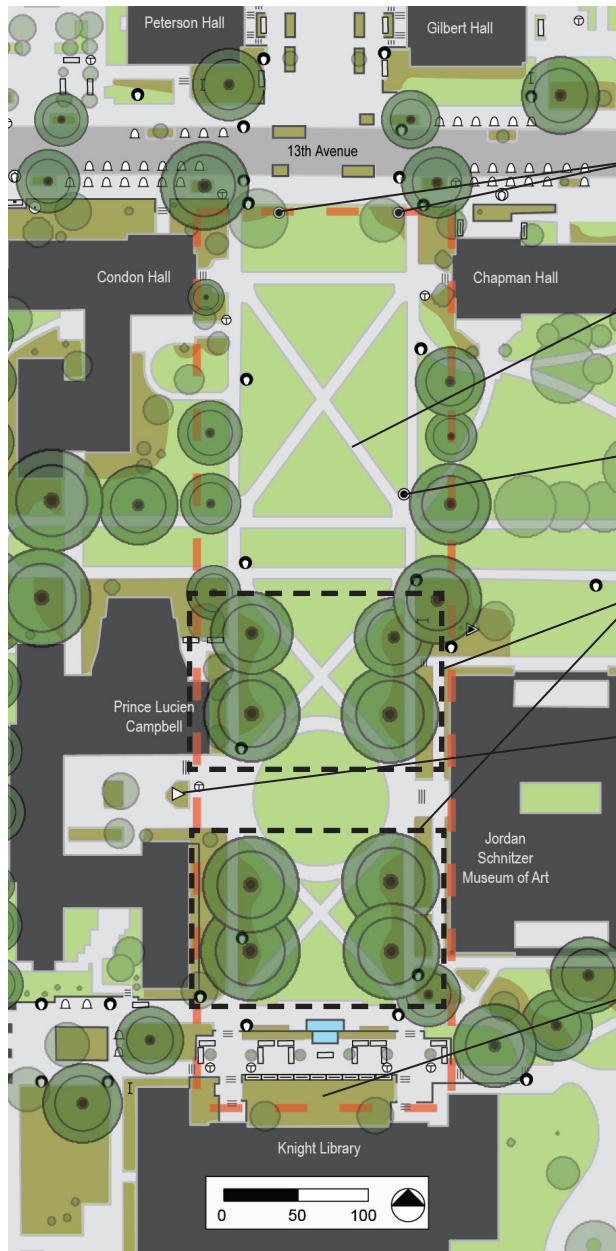

Two plaques dedicated in 1932 to honor the students who fought in the Spanish-American and the First World War

Concrete sidewalks constructed circa 1940

The Kincaid Field memorial plaque dedicated in 1921

Eight Pyramidal English oaks planted in 1940 to honor the senior class president of 1939, Robert Chase Bailey

The Falconer statue by James Lee Hansen (1973) and plaque with Ernest Hemingway inscription.

The Knight Library terrace and fountain were constructed in conjunction with the Library. A brass plaque is located on the fountain as part of Robert Bailey's memorial

LEGEND	
BIKE RACKS	
TRASH CANS	
NEWS STANDS	
SMALL SCALE FEATURES FROM PERIOD OF SIGNIFICANCE	
SMALL SCALE FEATURES AFTER PERIOD OF SIGNIFICANCE	
PLAQUES AND MEMORIALS FROM PERIOD OF SIGNIFICANCE	
PLAQUES AND MEMORIALS AFTER PERIOD OF SIGNIFICANCE	
BENCHES FROM PERIOD OF SIGNIFICANCE	
BENCHES AFTER PERIOD OF SIGNIFICANCE	
MEMORIAL BENCHES AFTER PERIOD OF SIGNIFICANCE	
TREES FROM PERIOD OF SIGNIFICANCE	
MEMORIAL TREES AFTER PERIOD OF SIGNIFICANCE	
CAMPUS TREES AFTER PERIOD OF SIGNIFICANCE	
UNIVERSITY STANDARD LIGHTPOSTS	
NON-UNIVERSITY STANDARD LIGHTPOSTS	
LANDSCAPE AREA BOUNDARY	

* note: Period of Significance refers to the project period of 1876-1974

SUMMARY OF EXISTING HISTORIC FEATURES

The Memorial Quadrangle was part of Ellis Lawrence’s plan for campus as early as 1914. Intended to be a key element of his grand entrance to campus, Lawrence envisioned a great axial view that initiated at the Dads’ Gates at 11th Avenue and eventually terminated at the head of the Memorial Quadrangle. The quadrangle was to be the university’s more formally-designed campus open space, and Lawrence initially proposed to build a great civic auditorium as its focal point, later to be replaced by the Library. The Quad gets its name from three distinct memorials. The first is a plaque dedicated in 1921 to the athletes who represented the University of Oregon on Kincaid Field. The second consists of the distinctive walks of the Quadrangle that honor the students who fought in the Spanish-American and First World Wars. The third consists of eight Pyramidal English oaks planted in 1940 to honor the senior class president of 1939, Robert Chase Bailey, who drowned in the Mill Race during his senior year. A brass plaque is located on the Library’s terrace fountain as part of this memorial.

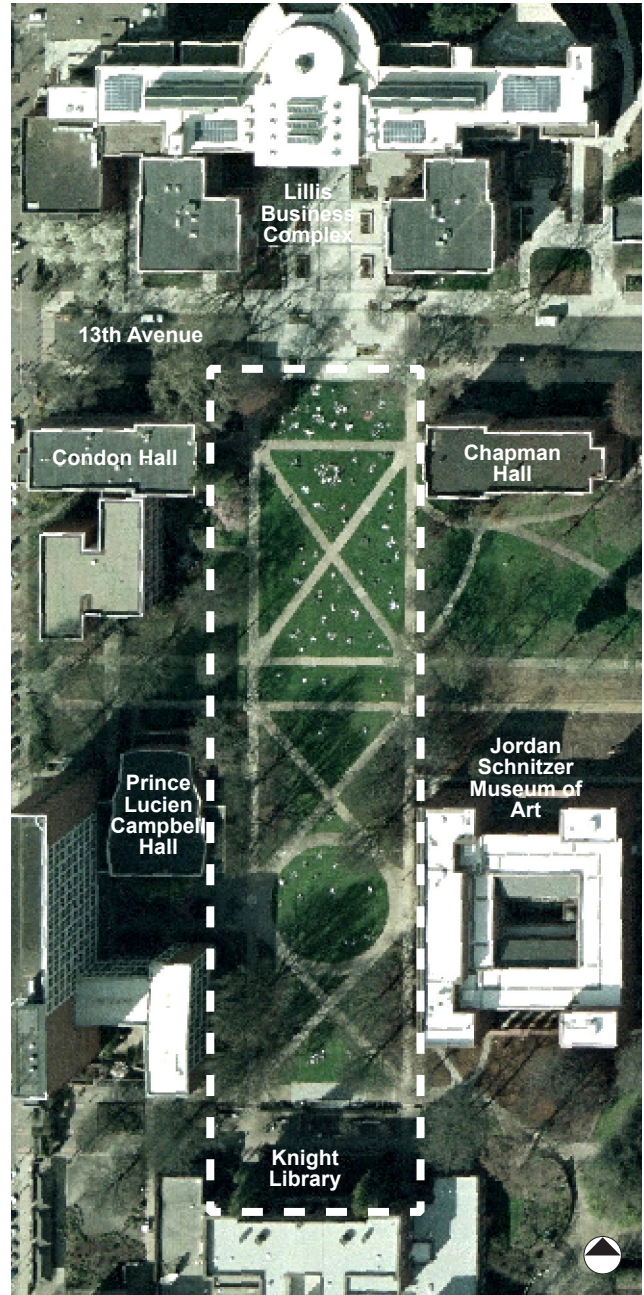

2004 aerial of the Memorial Quadrangle



A diagonal view toward Prince Lucien Campbell Hall.



Knight Library, at the head of the Memorial Quadrangle.

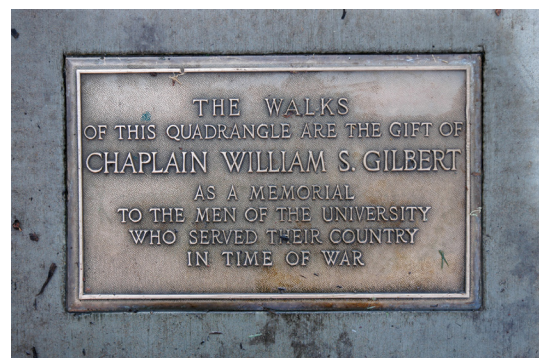

A plaque noting the gift of the Memorial Quadrangle.

■ **RESOURCE HISTORY**

ERA(S) OF GREATEST SIGNIFICANCE

Designated Eras within the Period of Historic Significance Determined for this Survey (1876-1974) are listed below. Check the era/eras determined to be of highest significance for this landscape area.

- Inception Era (1876-1913)
- Lawrence/Cuthbert Era (1914-1946)
- Mid-Century Era (1947-1974)

DATE(S) OF CONSTRUCTION DURING ERA(S) OF SIGNIFICANCE

- 1905: Kincaid Field is constructed.
- 1916: Peterson Hall is constructed.
- 1921: Gilbert Hall is constructed, open space of Memorial Quad officially dedicated to university athletes who played on what was formerly Kincaid Field.
- 1922: Kincaid Field grandstands are demolished.
- 1925: Condon Hall is constructed.
- 1930: Musuem of Art is constructed.
- 1932: Walks and landscape designed by Fred Cuthbert

ERA DESCRIPTION:

The Inception Era (1876-1913)

The Quadrangle as seen today had not been conceived during this era. The northern half of the site was occupied by Kincaid Field and the southern half was an empty field.

and dedicated to war heros.

1937: Main Library is constructed.

1939: Chapman Hall is constructed and the eight English oaks are planted in remembrance of Robert Bailey.

Circa 1940: The concrete walks of the Memorial Quad are completed.

MAJOR ALTERATIONS OCCURRING AFTER ERA(S) OF SIGNIFICANCE

- 1950: First Library addition.
- 1950: Johnson Lane, leading to the new EMU is completed.
- 1952: Commonwealth Hall is constructed.
- 1964: Prince Lucien Campbell Hall is constructed.
- 1966: Second Library addition.
- 1967-1968: Eight stories added to Prince Lucien Campbell Hall and Condon Hall addition.
- 1971: 13th Avenue is closed to auto traffic.
- 2003: Construction of the Lillis Business Complex, replacing Commonwealth Hall.
- 2004: Addition to the Museum of Art.

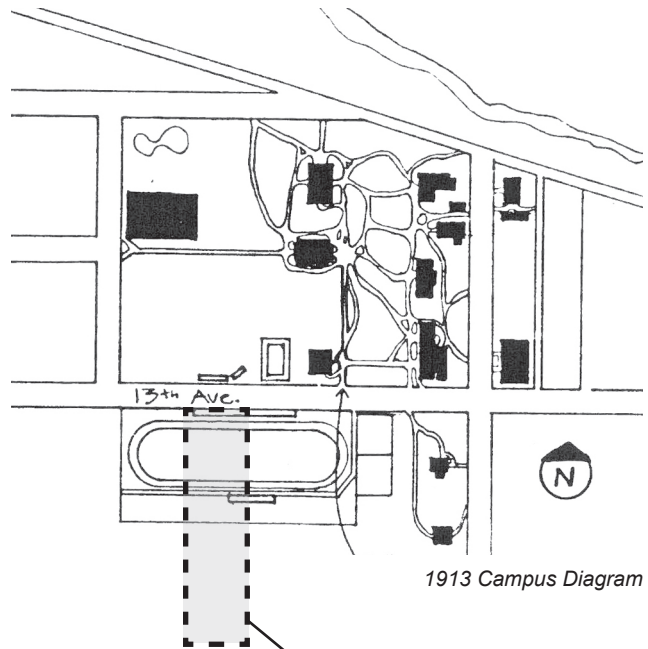

1913 Campus Diagram

Approximate location of the Memorial Quadrangle

Landscape Resource Survey
MEMORIAL QUADRANGLE

ERA DESCRIPTION:

The Lawrence/Cuthbert Era (1914-1946)

During this era Kincaid Field was replaced by the Memorial Quad, and Lawrence's grand signature open space was born. Gilbert and Peterson Halls help terminate the northern vista, with Condon and Chapman Halls marking the northern corners of the Quadrangle. The Library and Art Museum sat in a great open lawn that stretched all the way to Kincaid Street. The distinctive 'X' and 'O' paths of the Quad and the Library's terrace and fountain were designed by Cuthbert and put into place in 1932. The large circle walk served first as an automobile path to reach the art museum. Cuthbert kept this design and added the diagonals for pedestrians. Small trees like the eight Pyramidal English oaks dotted the exposed open space and the immature landscape of the Memorial Quadrangle was less than ten years old.



Looking north, with Kincaid Field in the foreground.

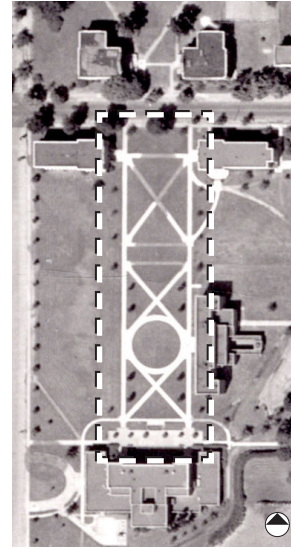

1944 aerial



1928 aerial

ERA DESCRIPTION:

The Mid-Century Era (1947-1974)

By the end of the Mid-Century Era, Commonwealth Hall was built between Gilbert and Peterson Halls, and more definitively terminated the view north. Most of the changes in the Quadrangle occurred on the western edge when Prince Lucien Campbell Hall rose to its full nine-story height, and an addition to Condon Hall moved the building's footprint within 80 feet of PLC's new auditorium. Johnson Lane was extended from Kincaid Street to the EMU upon its completion in 1950.



1950 aerial

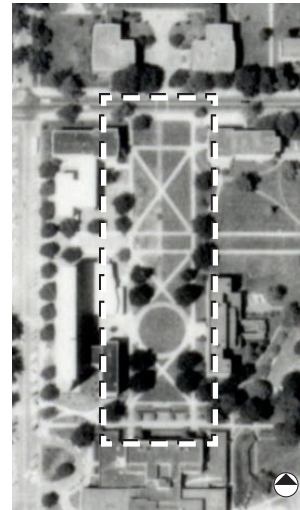

1968 aerial

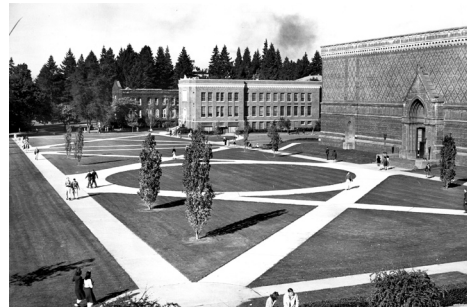

View of the Memorial Quad with the Museum on the right.

■ **DESCRIPTION OF LANDSCAPE CHARACTERISTICS**

LAND USE

Describing both the historic and current use of the Area.

Memorial Quadrangle is the largest of Ellis Lawrence’s designated open spaces. It is intentionally left open for the views and solar access, and is heavily used as an informal gathering place, hosting the occasional formal events such as graduation. The Quad also acts as a major connecting device between many prominent and historic buildings on campus.

DESIGN INTENT

Describing the overall design intent of the Area.

Memorial Quad was intended to be a formally-designed open space surrounded by some of the campus’ most important buildings. Ellis Lawrence envisioned the Memorial Quad as the academic core of campus, and it remains so today.

SPATIAL ORGANIZATION

Describing the arrangement of physical elements that create a three-dimensional sense of space.

True to form, Memorial Quad acts as an “outdoor room”, with all of the surrounding buildings having their front doors facing onto this space. The elongated north/south axis of the Quad emphasizes the building at its head, Knight Library. The English oaks planted in the southern part of the Quad help define the rectilinear shape of the space. The northern portion is very open with no

canopy cover.

TOPOGRAPHY & SITE ORIENTATION

Describe/document gradient, slope orientation and solar access.

The current topography of the Memorial Quad is on a consistent grade that slopes towards the north at an approximate 2-3% angle (see diagram below).

The intentional openness of the Memorial Quad allows for some of the highest solar access on campus, with the greatest exposure during the midday and afternoon hours.

VEGETATION

Describing tree, plant, shrub, ground layer groupings and arrangements.

The eight pyramidal English oaks at the southern end of the Quadrangle are significant trees, helping to give shape and form to the Quad. Aside from the pathways, the interior of the Quad is made up entirely of a mowed lawn. More diverse plantings of shrubs and perennials occur on the exterior edges along the north, south, and east edges of the Quad. The plantings in front of Knight Library are very formal, especially the low hedges of yew, boxwood and cotoneaster. A new planting of liriopse and clumping sedge are planted monotypically in front of the museum.

Flowering cherries were originally planted within the terrace and the cherries planted there today

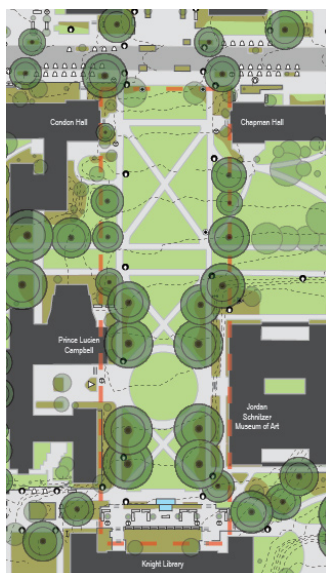

The area’s topography.

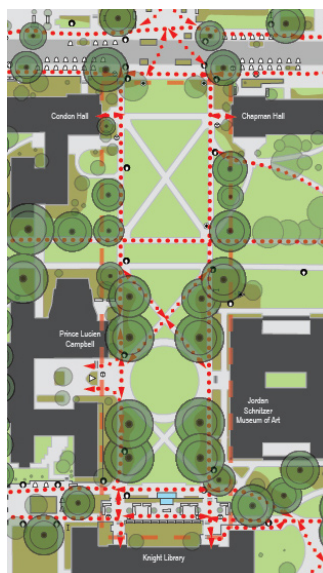
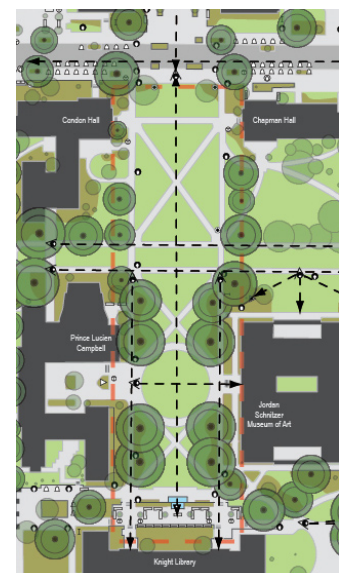

Diagram showing circulation paths.



Significant views through the area.

are most likely replacements. The boxwood hedge along the terrace's front wall most likely dates back to the Mid-Century Era. The tall Plume Sawara Cypresses, two in front of the Library and one in front of Condon Hall were planted during the Lawrence/Cuthbert Era.

NATURAL SYSTEMS AND FEATURES

Describing natural processes, water flow, and habitat, if applicable.

The eight large oaks are heavy acorn producers and are a good source of food for the campus squirrels. Aside from the oaks, the vast majority of the Quad is turf with little habitat value.

Most of the water is absorbed on site in the vast areas of pervious cover, and any excess water tends to drain off site to the north.

BUILDINGS/STRUCTURES

Describing built physical elements in and around perimeter of the Area, and their relationship to the landscape.

The Memorial Quad is flanked by buildings on all sides: to the east are Chapman Hall (1939) and the Museum of Art (1930); to the south and head of the Quad is Knight Library (1937); to the west are Prince Lucien Campbell Hall (1968) and Condon Hall (1925); and to the north, across 13th Avenue, lies the Lillis Business Complex (2003), which includes Peterson Hall (1916) and Gilbert Hall (1921).

The buildings within the Quad boundaries have primary entrances that face it, and display somewhat equivalent massings. The notable exception is Prince Lucien Campbell Hall at nine stories, though it has been set back some distance from the Quad.

SMALL-SCALE ELEMENTS

Describing elements such as monuments, markers, seating, fences etc.

There are numerous small-scale elements in the Memorial Quad that have historic significance, and include: a large concrete water feature and four brass water fountain basins along the masonry wall near Knight Library, cast stone benches, and two cast bronze drinking fountains (decommissioned), and four entry lights near the entry of the Library. There are plaques commemorating the location

of Kincaid Field and students who fought in the Spanish-American and the First World War. The two war plaques dedicated in 1932 read, "The walks of this Quadrangle are the gift of Chaplain William S. Gilbert, as a memorial to the men of the University who served their country in time of war."

EDGE CONDITIONS AND ADJACENCIES

Describing the perimeter of the site and important adjacent connections to spaces beyond.

The edge conditions are defined primarily by building faces along the east, north and south perimeter of the Quad, while the north portion is defined by 13th Avenue and the Lillis Business Complex beyond.

CIRCULATION

Describing movement paths and associated materials for: pedestrian; automobile; bicycle; other (e.g. system, alignment, materials, character).

Two linear north/south pathways form the east and west edges of the quadrangle and a series of east/west pathways cut across the Quad in a symmetrical nature. The circulation material is concrete, except for a flagstone section in front of the fountain near Knight Library. The Quad provides the primary access to the main entries of several buildings, including Knight Library, the Museum of Art, Prince Lucien Campbell Hall, Condon Hall and Chapman Hall. Three major east/west pathways – 13th Avenue, Johnson Lane, and Knight Library Axes – intersect this quadrangle (see diagram, pg. 6). An important pathway that leads to the Southwest Campus connects to this space along Kincaid Street.

VIEWS/VISTAS

Describing focal points and views to and from the Area.

The rectangular shape of the Quad provides long, linear views along the north/south axis (see diagram, page 6). There are also long east/west linear views where the Memorial Quad intersects with 13th Avenue, Johnson Lane Axis, and Knight Library Axis.

The most prominent view from the Quad is that between the Lillis Business Complex and Knight Library. There are also designed views across the Quad linking the buildings on each side.

■ **DETERMINATION OF SIGNIFICANCE**

CURRENT HISTORIC DESIGNATION

- City Landmark
- National Register - full listing
name: Library & Memorial Quad
- National Register - partial listing
name:
- National Historic Landmark
- No historic designation

NATIONAL REGISTER CRITERIA

Criterion A: Significant Events

Describe events with the landscape area that have influenced the broad patterns of campus history.

Not applicable.

Criterion B: Significant People

Describe connections with the lives of significant persons, including designers.

Not applicable.

Criterion C: Distinctive Characteristics

Describe elements that embody the distinctive characteristics of a type, period, or method of construction, or that represent the work of a master, or that possess high artistic values.

The Memorial Quad meets criterion C for its association with Ellis Lawrence's Campus Plan. As the University began to grow in population, Lawrence decided to expand in a new direction and chose the Memorial Quad as the main place around which to build new structures. The quadrangle was intended to be the most important open space on campus, with an important building as its focal point that eventually became Knight Library. The Quadrangle is arguably the most hallowed ground on campus, with three well-publicized memorials. It also represents work by well-known campus landscape architect, Fred Cuthbert. Cuthbert designed the walks and associated landscape features as well as the planting plan for the memorial trees to Robert Bailey. The Memorial Quadrangle is a key part to the heart of the university's academic core.

LEVEL OF SIGNIFICANCE

Rank the landscape area in term of its level of contribution to the historic significance of the university campus as a whole.

- High Significance
Considerable contribution to the history of the campus and its growth.
- Medium Significance
Noteworthy contribution the history of the campus and its growth.
- Low Significance
Discernable contribution to the history of the campus and its growth.
- Very Low/No Significance
No discernable importance to the history of the campus and its growth.



The Memorial Quad circa 1946, as viewed from what was probably the second story of the library.

■ DETERMINATION OF INTEGRITY

Integrity of the Landscape Area is evaluated based on the retention of the historic characteristics described in the categories below.

LOCATION / SETTING

Are important elements still in their original location and configuration?

The Memorial Quad retains a high degree of integrity from the Lawrence/Cuthbert Era. Many of Ellis Lawrence's most significant buildings, including the Museum of Art and Knight Library, spatially define this Quad.

DESIGN

How has the general structure of the landscape changed since its period of significance?

The general structure of the Quad has changed very little since the Lawrence/Cuthbert Era. The symmetrical walkways, plantings, and open lawn provide a formal quality to the space.

MATERIALS

Are original materials/vegetation that were used to structure and shape the landscape still present?

The English oaks are character defining trees within the Quad and they date back to the period of significance. The expansive lawn within the Quad is also in keeping with the historic design of the space.

WORKMANSHIP

Does the landscape retain characteristic workmanship from the period of significance?

Characteristic craftsmanship from the Lawrence/Cuthbert Era is evident throughout.

FEELING

Does the landscape evoke the period of significance?

The formal arrangement of pathways, the historic facades of the Lawrence/Cuthbert Era buildings, and the grand English oaks all evoke the period of significance.

ASSOCIATION

Is it possible to associate elements of the landscape with significant people/events?

This space retains high integrity and houses some of Ellis Lawrence's most significant buildings. The general configuration of Quad is also in keeping with Lawrence's master plan.

■ INTEGRITY & CONDITION FINDINGS

HISTORIC INTEGRITY

Determine the level of historic integrity, based on the Era(s) of Significance – check one

- Excellent Integrity
Retains a very high percentage of original fabric, and the original design intent is apparent.
- Good Integrity
Retains a significant percentage of original fabric, with a discernable design intent.
- Fair Integrity
Original fabric is present, but diminished.
- Poor Integrity
Contains little historic fabric, and the original design intent is difficult to discern.

OVERALL CONDITION OF LANDSCAPE AREA

– check one

- Excellent
- Good
- Fair
- Poor

■ RESOURCES

— List all primary sources used (plans, maps, surveys, photographs, drawings, newspapers, periodicals, and autobiographies) and secondary sources (books, theses, guidebooks).

Cuthbert, Fred A. drawing for the “Future Campus Entrance,” 1940. Photograph of original kept in the University of Oregon Special Collections, University of Oregon Photo Collection, Box 3, Campus Plans folder.

Emerson, Kim. National Register of Historic Places Registration Form for the University of Oregon Library and Memorial Quadrangle, 1990.

Force, Rachel. National Register of Historic Places Registration Form for the Dads’ Gates, 2004.

Lawrence, Ellis F. drawing for the “Plot Plan, University of Oregon,” 1914. Photograph of original kept in the University of Oregon Special Collections, University of Oregon Photo Collection, Box 3, Campus Plans folder.

Lawrence, Ellis F. drawing for the “Proposed Development Of The University Of Oregon Campus, Scheme No. 6,” 1932. Photograph of original kept in the University of Oregon Special Collections, University of Oregon Photo Collection, Box 3, Campus Plans folder.

Long, Stephen W. “Historic Continuity A Diagnosis Report” (Eugene: University of Oregon Office of Planning and Campus Development, 1980) 1-67.

Marshall Brothers, 1921 map of Campus, duplicate held by the University of Oregon Planning Office

Sandahl, David A. and Castro, Ricardo. “An architectural history of the University of Oregon,” (unpublished manuscript, University of Oregon, 1975) Architecture and Allied Arts Library

Shellenbarger, Michael. ed. *Harmony in Diversity: The Architecture and Teaching of Ellis F. Lawrence* (Eugene: University of Oregon, 1989), 1-91.

Teague, EH. (2004, Oct. 10). The Architecture of the University of Oregon. Retrieved Mar. 1, 2006, from <http://libweb.uoregon.edu/guides/architecture/oregon/>

University of Oregon, 1953 map of Campus, duplicate held by the University of Oregon Planning Office

University of Oregon Map Library, Aerial Photo Collection. Aerial photograph of the University of Oregon, 1936.

University of Oregon Map Library, Aerial Photo Collection. Aerial photograph of the University of Oregon, 1944.

University of Oregon Map Library, Aerial Photo Collection. Aerial photograph of the University of Oregon, 1947.

University of Oregon Map Library, Aerial Photo Collection. Aerial photograph of the University of Oregon, 1952.

University of Oregon Map Library, Aerial Photo Collection. Aerial photograph of the University of Oregon, 1960.

University of Oregon Map Library, Aerial Photo Collection. Aerial photograph of the University of Oregon, 1968.

Electronic version available on the University of Oregon Planning Office web page: <http://uplan.uoregon.edu/projects/HLP/hlpsurveyoflandareas.htm>

Survey research by Dustin Welch and Daniel Schaible.

Survey form completed in Spring 2006 under the supervision of Fletcher Farr Ayotte, Inc.

Edited by the University of Oregon Planning Office, Spring 2007.